



Shree  
**Sai Palace**  
2 & 3 BHK Deluxe flats  
@  
Kanakapura Main Road,  
Bangalore





## About

Welcome to 'Shree Sai Palace', an exclusive apartment complex which enjoys the unparalleled advantage of proximity to IT hubs and other industries, Shree Sai palace at Kanakapura Main Road, Bangalore, very close to schools, colleges, Temples, Shopping Malls, Hospitals .

Shree Sai Palace is spread over ground + four floors, offering 2 & 3 BHK luxurious apartments with good ventilation.

Shree Builders & Developers committed to bringing you a unique combination of the newest innovations in home building merged with finest traditions of quality construction. Headed by experienced professionals with a vision to transcend the ordinary, Shree Builders & Developers aims to incorporate environmentally friendly features into their building plans.





# Shree Sai Palace

2 & 3 BHK Deluxe flats



## FACILITIES :

- Budget prices, spacious and quality construction by reputed builders.
- Architecturally sound structure with provision for good Interior & 100% vastu achieved by reputed Architects.
- Continuous and round the clock bore well water supply.
- 24 X 7 security. CCTV Camera for security purpose (provision only).
- Adequate parking facility in the basement floor.
- Loan facility arranged by leading financial Institutions.
- Generator power backup for lift, pumps and common area lighting.
- Multi purpose hall .
- Gym room.
- Rain water harvesting
- Intercom facility





# Area Statements

SL. No.	FLOORS	SALEABLE AREAS IN S.F.T.							
1.	Ground Floor	001 1460	002 1005	003 1360	004 1060	005 1425	006 1010	007 1365	008 1072
2.	First Floor	101 1460	102 1005	103 1360	104 1060	105 1425	106 1010	107 1365	108 1072
3.	Second Floor	201 1460	202 1005	203 1360	204 1060	205 1425	206 1010	207 1365	208 1072
4.	Third Floor	301 1460	302 1005	303 1360	304 1060	305 1425	306 1010	307 1365	308 1072
5.	Fourth Floor	401 1460	402 1005	403 1360	404 1060	405 1425	406 1010	407 1365	408 1072

## Shree Sai Palace

2 & 3 BHK Deluxe flats

Typical floor plan

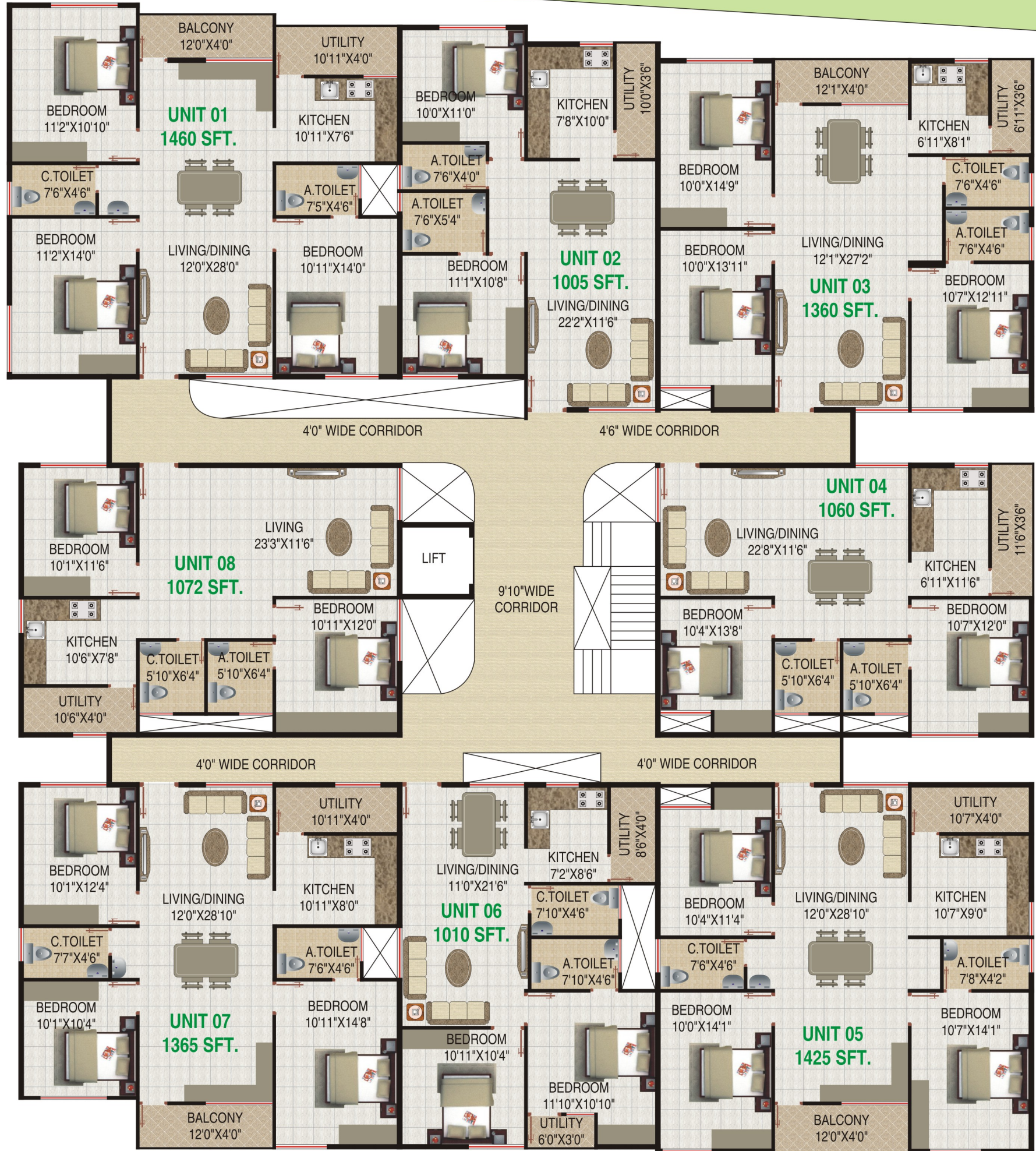

WEST BY ROAD



# Specifications



## Structure

R.C.C framed structure designed for zone II regulations.



## Walls

6" thick external walls and 4" thick internal walls of solid block masonry.



## Plastering

Smooth finish with lime rendering for interior and sponge finish for exterior.



## Doors

- Main door frame of teak wood with teak wood shutter.
- All other door frames of sal wood with flush door with enamel paint.



## Windows

UPVC windows with MS safety grills.

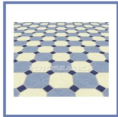

## Flooring

- Vitrified tile flooring for living, dining, kitchen and bedrooms
- Ceramic tile flooring in bathrooms with glazed tiles upto 7'0" height.
- Granite flooring for staircase & lobbies.



## Kitchen

40 mm granite counter top with SS sink (Single Bowl).  
3' height glazed tile dadoing above plot form.



## Electrical

Concealed conduiting for wiring with finolex cables & wires and Anchor Roma / GM switches.



## Bathrooms/Toilets

Basic Jaguar fittings with hindware sanitary ware in bathrooms.  
Plumbing with approved CPVC pipes, fittings etc.



## Painting

Internal : Acrylic Tractor Emulsion  
External : Weather proof paint (APEX).



## Lift

1 no. eight passenger lift.



## Isometric Views



# Car parking floor plan

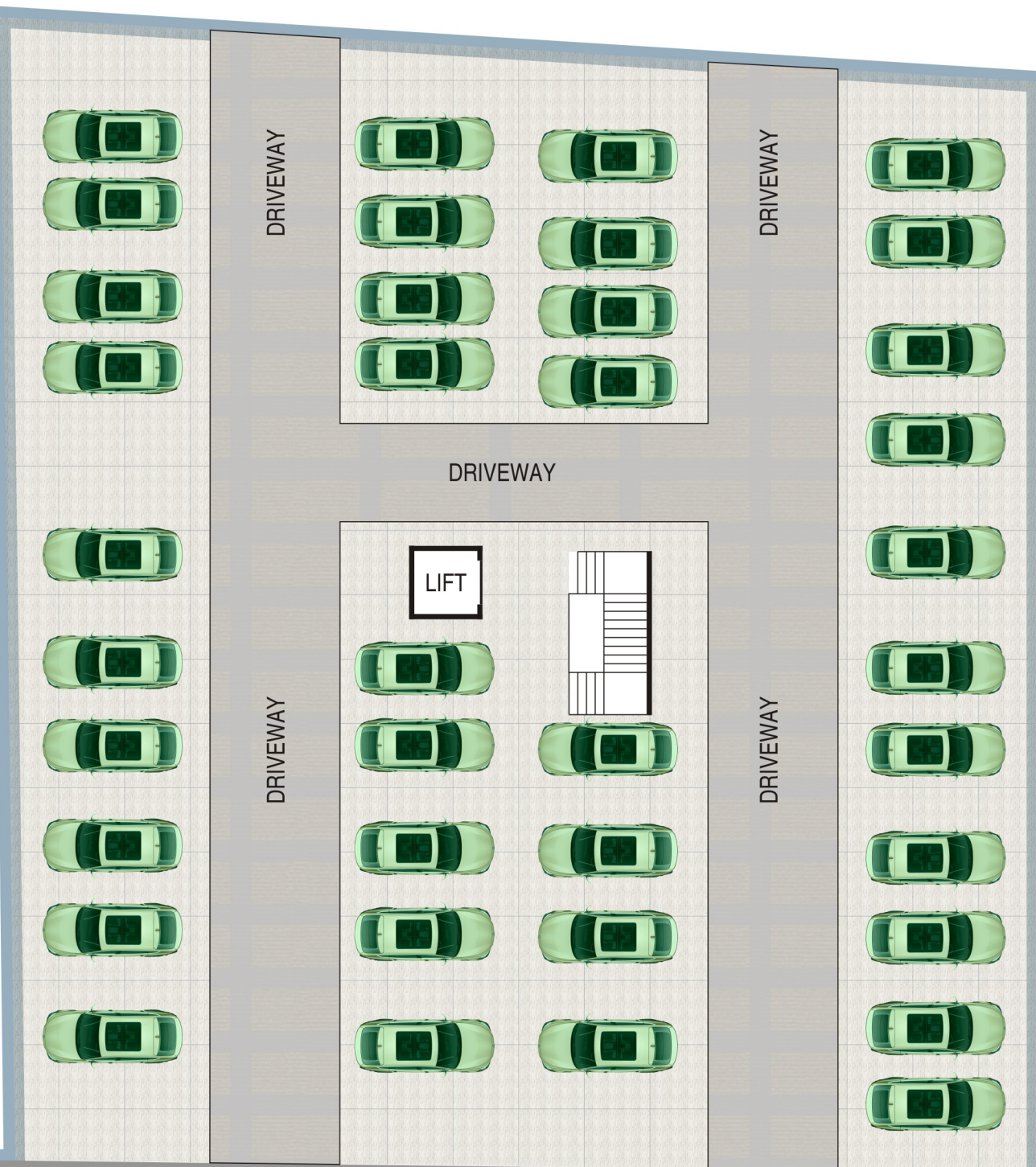

# Shree Sai Palace

2 & 3 BHK Deluxe flats

### Proximity

- Project is very close to
- Kanakapura Main Road
  - Metro Station
  - Bannerghatta Main Road
  - Mysore Road
  - Nice Road
  - Uttarahalli
  - JP Nagar
  - Banashankari

### Hospitals

- (NU Hospital) Kidney Foundation
- BGS Global Hospital
- Sagar Hospital
- Sevakshetra

### Super Markets

- Metro
- Big Bazaar
- & much more ...

### Educational Institutions

- Suryodaya School
- Ekya School
- Jnana Sweekar
- Yashasvi Intl. School
- DPS South
- KSIT
- Yellamma Dasappa IT
- APSIT
- Dayananda Sagar Institutions
- Jyothy Engg. College
- and much more...



WEST BY ROAD



# Location Map



For details contact :

**Mr. Prasad**

Mobile : 9686511662

**Mr. Krishnamoorthy**

Mobile : 9448118453



2 & 3 BHK Deluxe flats

@ 6 & 7, Doddakallasandra,  
Off Kanakapura Main Road,  
Bangalore.



**Builders & Developers**

No. 6, KEB Layout, Kathriguppe Main Road,  
BSK 3rd Stage, Vivekananda Nagar,  
Bangalore - 560 085. Phone : 9611443355

Website : [www.shreebnd.com](http://www.shreebnd.com)

Email : [info@shreebnd.com](mailto:info@shreebnd.com)

This leaflet is purely conceptual in nature and is by no means a legal document.  
The promoters, developers & architects reserve the right to add, delete or alter any specification or elevation mentioned herein.

Design & execution by YASHAS, M : 98443 59444